

PRODUCT NUMBER	DIM B	DIM L	MATING SOCKET PART NUMBERS	THREADED DEPTH
50271-001	.227/5.77	.382/9.70	90306,91506	.165/4.19 MIN.
50271-001LF	.227/5.77	.382/9.70	90306,91506	.165/4.19 MIN.
50271-002	.296/7.52	.451/11.45	90306,91506	.165/4.19 MIN.
50271-002LF	.296/7.52	.451/11.45	90306,91506	.165/4.19 MIN.
50271-003	.365/9.27	.520/13.20	90306,91506	.165/4.19 MIN.
50271-003LF	.365/9.27	.520/13.20	90306,91506	.165/4.19 MIN.
50271-004	.296/7.52	.451/11.45	90306,91506	.250/6.35 MIN.
50271-004LF	.296/7.52	.451/11.45	90306,91506	.250/6.35 MIN.

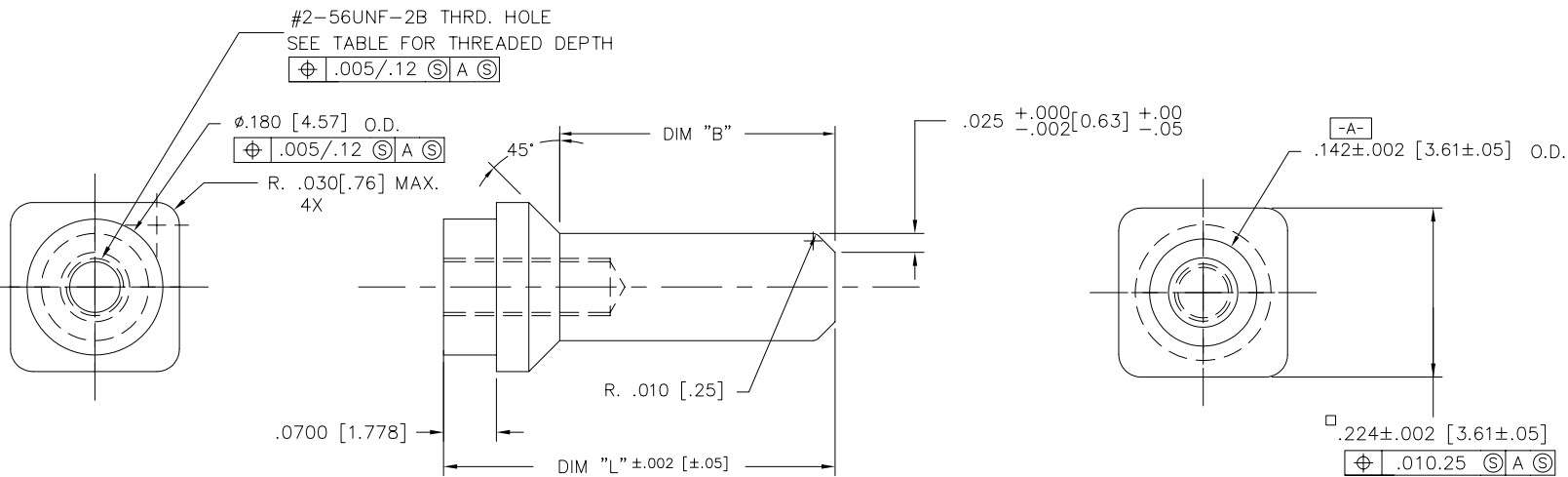

NOTES:

- MATERIAL: PHOS BRONZE
- PLATING: 30u"/.76u MIN Au OVER
50u"/1.27u MIN Ni
- UNSPECIFIED ANGLES - 45°.
- VARIATIONS SHOWN ON THIS PRINT ARE "STANDARD" PIN LENGTHS. SEE P/N 91409 FOR "SPECIAL" PIN LENGTHS.
- SURFACE FINISH IN CONTACT AREA NOT TO EXCEED 25 RMS.
- PRODUCT NUMBERS WITH AN LF SUFFIX MEET EUROPEAN UNION DIRECTIVES AND OTHER COUNTRY REGULATIONS AS DESCRIBED IN GS-22-008.
- THIS PRODUCT IS NOT INTENDED TO BE EXPOSED TO MANUFACTURING SOLDER PROCESSES.

mat'l. code		surface ISO 1302 <input checked="" type="checkbox"/>		tolerance ISO 406 ISO 1101		projection 		product family HPC		
ltr	ecn no	dr	date	tolerances unless otherwise specified		INCH/MM		title		
D	V31883	GIP	10/28/93	angles	.XX±.01/.3			POWER PIN SCREW MOUNT		
E	V40398	MDF	2/16/94	linear	.xxx±.005/.13					
F	V00558	LSS	3/2/00	0°±2'	.xxxx±.0020/.051	scale 1:1				
G	V05-0561	DAI	6/16/05	dr	D. SHEAFFER	3/27/92		dwg no		
H	V05-0681	DAI	7/20/05	enr	S. CLARK	4/28/92		sheet 1 of 1 size		
J	V05-1072	HTB	11/23/05	chr	S. CLARK	4/28/92		50271 A3		
K	M06-0265	AGS	7/10/06	appd	S. CLARK	4/28/92		type Product Customer Drawing		
sheet	revision									
index	sheet	1								



Copyright FCI